



---

1250 West Century Avenue  
Mailing Address:  
P.O. Box 5601  
Bismarck, ND 58506-5601  
(701) 530-1600

August 4, 2022

Kimberly D. Bose, Secretary  
Federal Energy Regulatory Commission  
888 First Street, N.E., Room 1A  
Washington, D.C. 20426

Re: WBI Energy Transmission, Inc.  
Docket Nos. CP20-52-000 and CP20-52-001  
North Bakken Expansion Project  
Status Report No. 47

Dear Ms. Bose:

WBI Energy Transmission, Inc. (WBI Energy) herewith submits its Weekly Status Report No. 47 for the North Bakken Expansion Project, in compliance with Environmental Condition 8 of the Appendix to the Federal Energy Regulatory Commission's (Commission) June 1, 2021 Order Issuing Certificate in the above referenced dockets.

On January 26, 2022, the Commission granted WBI Energy's request to place the North Bakken Expansion Project into service. On February 1, 2022, the authorized facilities were placed into service.

The attached report addresses the period July 25, 2022 to July 31, 2022.

Should you have any questions or comments regarding this filing, please call the undersigned at (701) 530-1563.

Sincerely,

/s/ Lori Myerchin

Lori Myerchin  
Director, Regulatory Affairs and  
Transportation Services

Courtesy Copies:

Dawn Ramsey, FERC



**WBI Energy Transmission, Inc.**  
**North Bakken Expansion Project Status Report No. 47**  
**FERC Docket Nos. CP20-52-000**  
**CP20-52-001**

**Reporting Period:** July 25, 2022 through July 31, 2022

**A. Update on Federal Authorizations**

WBI Energy has obtained all necessary federal permits and authorizations required for construction of the North Bakken Expansion Project.

- On January 26, 2022, the Commission granted WBI Energy’s request for authorization to place all Project facilities into service.
- On February 1, 2022, the authorized facilities were placed into service.

**B. Construction Status - Pipeline Facilities**

- Continued follow-up restoration work on the Tioga-Elkhorn Creek Pipeline right-of-way as conditions allowed.
- Continued monitoring the pipeline right-of-way and erosion control devices around Project sites. Environmental Inspectors documented areas that will require follow-up restoration work and verified repairs in areas that were addressed.
- Environmental Inspectors conducted onsite environmental training as needed.

**TABLE 1-1**  
**Williston-Tioga-Minot Reroute <sup>1</sup>**

<b>Work Completed during Reporting Period</b>			
<ul style="list-style-type: none"> <li>• No work occurred during the reporting period.</li> </ul>			
<b>Activity</b>	<b>Completed Total % Completed This Period</b>	<b>% of Total Job Completed</b>	<b>Comments</b>
<b>Pipeline</b>			
Clearing / Grading		100%	
Stringing		100%	
Bending		100%	
Welding		100%	
Joint Coating		100%	
Ditching		100%	
Lowering		100%	
Backfill		100%	
Cleanup		100%	

<sup>1</sup> This reroute was included as part of WBI Energy’s response to Environmental Condition 5 of its June 8, 2021 Response to Environmental Conditions of Order Issuing Certificate (Attachment 5-1, Table 5A, Modification Reference ID AF-1).

Seeding		100%	
Hydrostatic Testing		100%	

**Work Planned for next Reporting Period and Schedule Changes:**

- No work is planned for the next reporting period.

**Problem Areas, Corrective Actions and Effectiveness:**

- No problem areas were identified during reporting period.

**Non-Compliance Issues, Corrective Actions and Effectiveness:**

- No non-compliance issues were identified during reporting period.

**Non-Compliance Issues from Federal, State or Local Permitting Agencies and Response:**

- No non-compliance issues were identified during reporting period.

Copies included: Not applicable.

**Landowner Issues:** None

Date	Name	Milepost / Alignment Sheet #	Problem/Concern	Corrective Action

**TABLE 1-2  
Line Section 30 Loop**

<b>Work Completed during Reporting Period:</b>				
<ul style="list-style-type: none"> <li>No work occurred during the reporting period.</li> </ul>				
Activity	Total % Completed This Period	% of Total Job Completed	Comments	
<b>Pipeline</b>				
Clearing / Grading		100%		
Stringing		100%		
Bending		100%		
Welding		100%		
Joint Coating		100%		
Ditching		100%		
Lowering		100%		
Backfill		100%		
Cleanup		100%		
Seeding		100%		
Pig Launcher/Receiver <sup>2</sup>		2 of 2	Pig launcher/receivers completed	
Block Valve <sup>3</sup>		1 of 1	Block Valve completed	
Bores		8 of 8	Bores completed	
Hydrostatic Testing		100%		
<b>Work Planned for next Reporting Period and Schedule Changes:</b>				
<ul style="list-style-type: none"> <li>No work is planned for the next reporting period.</li> </ul>				
<b>Problem Areas, Corrective Actions and Effectiveness: Possible:</b>				
<ul style="list-style-type: none"> <li>No problem areas were identified during reporting period.</li> </ul>				
<b>Non-Compliance Issues, Corrective Actions and Effectiveness:</b>				
<ul style="list-style-type: none"> <li>No non-compliance issues were identified during reporting period.</li> </ul>				
<b>Non-Compliance Issues from Federal, State or Local Permitting Agencies and Response:</b>				
<ul style="list-style-type: none"> <li>No non-compliance issues were identified during reporting period.</li> </ul>				
Copies included: Not applicable				
<b>Landowner Issues: None</b>				
Date	Name	Milepost / Alignment Sheet #	Problem/Concern	Corrective Action

<sup>2</sup> Includes a pig launcher / receiver at the Nesson valve setting (MP 0.0) and the Tioga Compressor Station (MP 9.6). Restoration included backfilling at both locations. The Nesson pig launcher/receiver and the Temple block valve will have a security fence installed around both facilities and gravel spread in Spring 2022 after the removal of the old block valve. Final restoration of the Tioga pig launcher/receiver will be completed in conjunction with the final restoration of the Tioga Compressor Station.

<sup>3</sup> The Temple Valve site (MP 0.0) was included as part of WBI Energy’s response to Environmental Condition 5 of its June 8, 2021 Response to Environmental Conditions of Order Issuing Certificate (Attachment 5-1, Table 5A, Modification Reference ID LS30-1).

**TABLE 1-3a**  
**Tioga-Elkhorn Creek Pipeline- Spread 1 (MP 0.0 to 23.0)**

**Work Completed during Reporting Period:**

- Continued addressing areas that require follow-up restoration work.
- Continued reseeded and straw mulch application in non-cultivated fields where settling and erosion issues were addressed. The same seed-mix and rates used in the Fall 2021 were used in the reseeded. The seed mix and rates are based on landowner preference, local soil conservation authority recommendations, or applicable land management agency requirements.

Activity	Total % Completed This Period	% of Total Job Completed	Comments
<b>Pipeline</b>			
Clearing / Grading		100%	
Stringing		100%	
Bending		100%	
Welding		100%	
Joint Coating		100%	
Ditching		100%	
Lowering		100%	
Backfill		100%	
Cleanup		100%	
Seeding		100%	
Pig Launcher/Receiver <sup>4</sup>		2 of 2	Pig launcher/receivers completed
Block Valve <sup>5</sup>		1 of 1	Block valve completed
Bores		20 of 20	Bores completed
Hydrostatic Testing		100%	

**Work Planned for next Reporting Period and Schedule Changes:**

- Continue to address areas that require follow-up restoration work.

**Problem Areas, Corrective Actions and Effectiveness:**

- No problem areas were identified during reporting period.

**Non-Compliance Issues, Corrective Actions and Effectiveness:**

- No non-compliance issues were identified during reporting period.

**Non-Compliance Issues from Federal, State or Local Permitting Agencies and Response:**

- No non-compliance issues were identified during reporting period.

Copies included: Not applicable

**Landowner Issues: None**

Date	Name	Milepost / Alignment Sheet #	Problem/Concern	Corrective Action

<sup>4</sup> Includes a pig launcher / receiver at the Tioga Compressor Station (MP 0.0) and at 104<sup>th</sup> Avenue NW (MP 6.2). Restoration included backfilling at both locations. Final restoration of the Tioga pig launcher/receiver will be completed in conjunction with the final restoration of the Tioga Compressor Station. The 104<sup>th</sup> Avenue pig launcher/receiver had a security fence installed and gravel spread.

<sup>5</sup> Includes a block valve at 56<sup>th</sup> Street NW (MP 16.2). Restoration included backfilling, a security fence installed, and gravel spread.



Date: 7/25/2022

Location:  
Sta. No. 784+50

Notes: Repairing  
rill/channel erosion  
on the Tioga-  
Elkhorn Creek  
Pipeline right-of-  
way.



Date: 7/25/2022

Location:  
Sta. No. 817+50

Notes: Repaired  
right-of-way prior  
to reseeding the  
Tioga-Elkhorn  
Creek Pipeline  
right-of-way.





Date: 7/26/2022

Location:  
Sta. No. 852+25

Notes: Repaired  
rill/channel erosion  
on the Tioga-  
Elkhorn Creek  
Pipeline right-of-  
way.



Date: 7/26/2022

Location:  
Sta. No. 856+75

Notes: Repairing  
trench settling on  
the Tioga-Elkhorn  
Creek Pipeline  
right-of-way.



Date: 7/27/2022

Location:  
Sta. No. 755+00

Notes: Repairing  
trench settling on  
the Tioga-Elkhorn  
Creek Pipeline  
right-of-way.



Date: 7/27/2022

Location:  
Sta. No. 854+50

Notes: Installed  
erosion control  
devices in a bar  
ditch on the Tioga-  
Elkhorn Creek  
Pipeline.





Date: 7/28/2022

Location:  
Sta. No. 1016+50

Notes: Repaired  
rill/channel erosion  
on the Tioga-  
Elkhorn Creek  
Pipeline right-of-  
way.

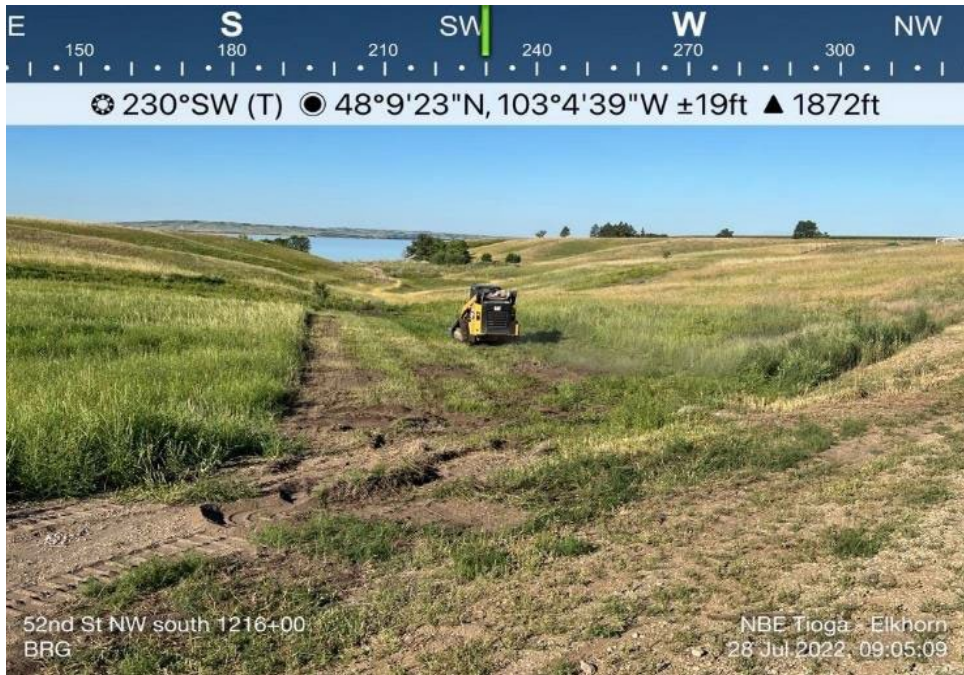

Date: 7/28/2022

Location:  
Sta. No. 1216+00

Notes: Mowing  
prior to repairing  
rill/channel erosion  
on the Tioga-  
Elkhorn Creek  
Pipeline right-of-  
way.





Date: 7/29/2022

Location: Sta. Nos.  
963+60 to 975+50

Notes: Crimped  
straw mulch into  
reseeded right-of-  
way to anchor  
mulch on the Tioga-  
Elkhorn Creek  
Pipeline.



Date: 7/29/2022

Location:  
Sta. No. 1016+00

Notes: Crimping  
straw mulch into  
reseeded right-of-  
way to anchor  
mulch on the Tioga-  
Elkhorn Creek  
Pipeline.



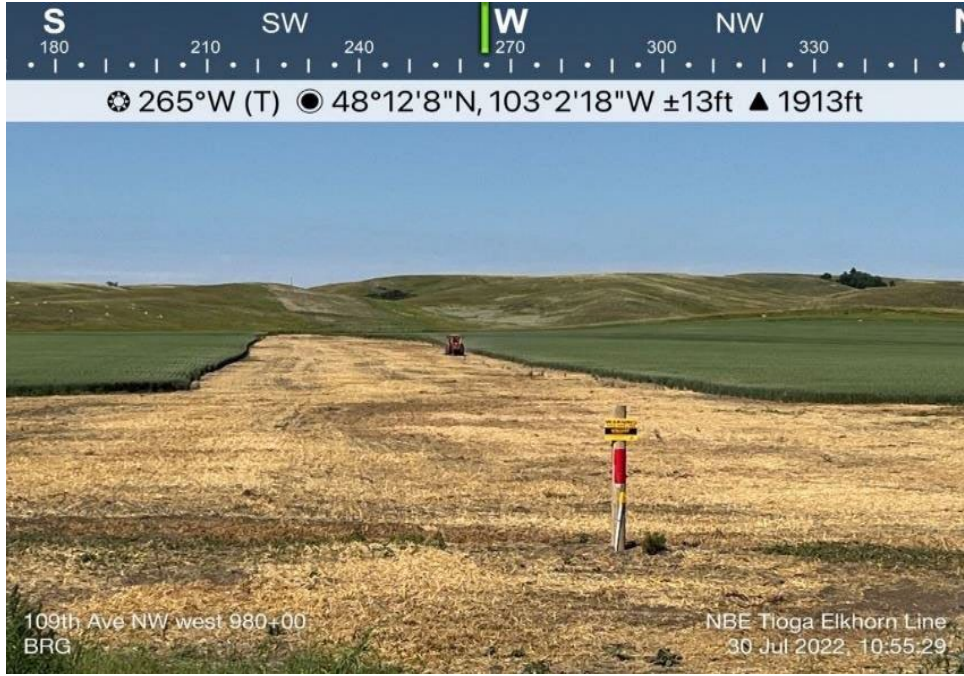

Date: 7/30/2022

Location:  
Sta. No. 980+00

Notes: Crimping straw mulch into reseeded right-of-way to anchor mulch on the Tioga-Elkhorn Creek Pipeline.



Date: 7/30/2022

Location:  
Sta. No. 1215+00

Notes: Installed erosion control devices on repaired Tioga-Elkhorn Creek Pipeline right-of-way.

**TABLE 1-3b  
Tioga-Elkhorn Creek Pipeline- Spread 2 (MP 23.0 to 62.8)**

<b>Work Completed during Reporting Period:</b>				
<ul style="list-style-type: none"> <li>No work was completed during this reporting period.</li> </ul>				
Activity	Total % Completed This Period	% of Total Job Completed	Comments	
<b>Pipeline</b>				
Clearing / Grading		100%		
Stringing		100%		
Bending		100%		
Welding		100%		
Joint Coating		100%		
Ditching		100%		
Lowering		100%		
Backfill		100%		
Cleanup		100%		
Seeding		100%		
Pig Launcher/Receiver <sup>6</sup>		1 of 1	Pig launcher/receiver completed	
Block Valves <sup>7</sup>		3 of 3	Block Valves completed	
Bores		38 of 38	Bores completed	
Hydrostatic Testing		100%		
<b>Work Planned for next Reporting Period and Schedule Changes:</b>				
<ul style="list-style-type: none"> <li>Continue to address areas that require follow-up restoration work.</li> </ul>				
<b>Problem Areas, Corrective Actions and Effectiveness:</b>				
<ul style="list-style-type: none"> <li>No problem areas were identified during reporting period.</li> </ul>				
<b>Non-Compliance Issues, Corrective Actions and Effectiveness:</b>				
<ul style="list-style-type: none"> <li>No non-compliance issues were identified during reporting period.</li> </ul>				
<b>Non-Compliance Issues from Federal, State or Local Permitting Agencies and Response:</b>				
<ul style="list-style-type: none"> <li>No non-compliance issues were identified during reporting period.</li> </ul>				
Copies included: Not applicable				
Landowner Issues: None				
Date	Name	Milepost / Alignment Sheet #	Problem/Concern	Corrective Action

<sup>6</sup> Includes a pig launcher / receiver at the Elkhorn Compressor Station (MP 62.8). Restoration included backfilling. Final restoration of the Elkhorn pig launcher/receiver will be completed in conjunction with the final restoration of the Elkhorn Compressor Station.

<sup>7</sup> Includes block valves at South Lake (MP 26.2), Highway 10 (MP 37.0) and Cherry Creek (MP 51.4). Restoration included backfilling, a security fence installed, and gravel spread at both locations.



**TABLE 1-4a  
Lake Sakakawea HDD  
North Side of Lake Sakakawea**

**Work Completed during Reporting Period**

- No work was completed during this reporting period.

Activity	Total % Completed This Period	% of Total Job Completed	Comments
<b>Pipeline</b>			
Site Prep		100%	
Stringing		100%	
Bending	N/A	N/A	
Welding		100%	
Joint Coating		100%	
Pilot Hole Drilling		100%	The pilot hole intersect was completed on September 17, 2021.
Reaming Operations		100%	
Pipe Installation		100%	Completed on October 25, 2021.
Hydrostatic Testing		100%	

**Work Planned for next Reporting Period and Schedule Changes:**

- No work is planned for the next reporting period.

**Problem Areas, Corrective Actions and Effectiveness:**

- No problem areas were identified during reporting period.

**Non-Compliance Issues, Corrective Actions and Effectiveness:**

- No non-compliance issues were identified during reporting period.

**Non-Compliance Issues from Federal, State or Local Permitting Agencies and Response:**

- No non-compliance issues were identified during reporting period.

Copies included: Not applicable

**Landowner Issues:** None

Date	Name	Milepost / Alignment Sheet #	Problem/Concern	Corrective Action

**TABLE 1-4b**  
**Lake Sakakawea HDD**  
**South Side of Lake Sakakawea**

**Work Completed during Reporting Period**

- No work was completed during this reporting period.

Activity	Total % Completed This Period	% of Total Job Completed	Comments
<b>Pipeline</b>			
Site Prep		100%	
Pilot Hole Drilling		100%	The pilot hole intersect was completed on September 17, 2021.
Reaming Operations		100%	
Swab Pass		100%	
Pull Back & Pipe Installation		100%	Completed on October 25, 2021.

**Work Planned for next Reporting Period and Schedule Changes:**

- No work is planned for the next reporting period.

**Problem Areas, Corrective Actions and Effectiveness:**

- No problem areas were identified during reporting period.

**Non-Compliance Issues, Corrective Actions and Effectiveness:**

- No non-compliance issues were identified during reporting period.

**Non-Compliance Issues from Federal, State or Local Permitting Agencies and Response:**

- No non-compliance issues were identified during reporting period.

Copies included: Not applicable

**Landowner Issues:** None

Date	Name	Milepost / Alignment Sheet #	Problem/Concern	Corrective Action

**TABLE 1-5  
Tioga Compressor Lateral**

<b>Work Completed during Reporting Period:</b>				
<ul style="list-style-type: none"> <li>No work was completed during this reporting period.</li> </ul>				
Activity	Total % Completed This Period	% of Total Job Completed	Comments	
<b>Pipeline</b>				
Clearing / Grading		100%		
Stringing		100%		
Bending		100%		
Welding		100%		
Joint Coating		100%		
Ditching		100%		
Lowering		100%		
Backfill		100%		
Cleanup		100%		
Seeding		100%		
Pig Launcher/Receiver <sup>8</sup>		2 of 2	Pig launcher/receivers completed	
Bores		1 of 1	Bore completed	
Hydrostatic Testing		100%		
<b>Work Planned for next Reporting Period and Schedule Changes:</b>				
<ul style="list-style-type: none"> <li>Continue to address areas that require follow-up restoration work.</li> </ul>				
<b>Problem Areas, Corrective Actions and Effectiveness:</b>				
<ul style="list-style-type: none"> <li>No problem areas were identified during reporting period.</li> </ul>				
<b>Non-Compliance Issues, Corrective Actions and Effectiveness:</b>				
<ul style="list-style-type: none"> <li>No non-compliance issues were identified during reporting period.</li> </ul>				
<b>Non-Compliance Issues from Federal, State or Local Permitting Agencies and Response:</b>				
<ul style="list-style-type: none"> <li>No non-compliance issues were identified during reporting period.</li> </ul> Copies included: Not applicable				
<b>Landowner Issues:</b> None				
Date	Name	Milepost / Alignment Sheet #	Problem/Concern	Corrective Action

<sup>8</sup> Includes pig launcher/receivers at the Tioga Plant Receipt Station (MP 0.0) and the Tioga Compressor Station (MP 0.5). Restoration included backfilling at both locations. Final restoration of the Tioga Plant Receipt Station and the Tioga Compressor Station pig launcher/receivers will be completed in conjunction with the final restoration of the stations.

**TABLE 1-6  
Elkhorn Creek to Northern Border Interconnect Pipeline**

**Work Completed during Reporting Period**

- No work was completed during this reporting period.

Activity	Total % Completed This Period	% of Total Job Completed	Comments
<b>Pipeline</b>			
Clearing / Grading		100%	
Stringing		100%	
Bending		100%	
Welding		100%	
Joint Coating		100%	
Ditching		100%	
Lowering		100%	
Backfill		100%	
Cleanup		100%	
Seeding		100%	
Block Valve		1 of 1	Block valve completed
Hydrostatic Testing		100%	

**Work Planned for next Reporting Period and Schedule Changes:**

- No work is planned for the next reporting period.

**Problem Areas, Corrective Actions and Effectiveness:**

- No problem areas were identified during reporting period.

**Non-Compliance Issues, Corrective Actions and Effectiveness:**

- No non-compliance issues were identified during reporting period.

**Non-Compliance Issues from Federal, State or Local Permitting Agencies and Response:**

- No non-compliance issues were identified during reporting period.

Copies included: Not applicable

**Landowner Issues:** None

Date	Name	Milepost / Alignment Sheet #	Problem/Concern	Corrective Action



**TABLE 1-7  
Line Section 25 Loop**

<b>Work Completed during Reporting Period:</b>				
<ul style="list-style-type: none"> <li>No work was completed during this reporting period.</li> </ul>				
Activity	Total % Completed This Period	% of Total Job Completed	Comments	
<b>Pipeline</b>				
Clearing / Grading		100%		
Stringing		100%		
Bending		100%		
Welding		100%		
Joint Coating		100%		
Ditching		100%		
Lowering		100%		
Backfill		100%		
Cleanup		100%		
Seeding		100%		
Pig Launcher/Receiver <sup>9</sup>		2 of 2	Pig launcher/receivers completed	
Block Valves <sup>10</sup>		2 of 2	Block Valves completed	
Bores		27 of 27	Bores completed	
Hydrostatic Testing		100%		
<b>Work Planned for next Reporting Period and Schedule Changes:</b>				
<ul style="list-style-type: none"> <li>No work is planned for the next reporting period.</li> </ul>				
<b>Problem Areas, Corrective Actions and Effectiveness:</b>				
<ul style="list-style-type: none"> <li>No problem areas were identified during reporting period.</li> </ul>				
<b>Non-Compliance Issues, Corrective Actions and Effectiveness:</b>				
<ul style="list-style-type: none"> <li>No non-compliance issues were identified during reporting period.</li> </ul>				
<b>Non-Compliance Issues from Federal, State or Local Permitting Agencies and Response:</b>				
<ul style="list-style-type: none"> <li>No non-compliance issues were identified during reporting period.</li> </ul> Copies included: Not applicable				
<b>Landowner Issues:</b> None				
Date	Name	Milepost / Alignment Sheet #	Problem/Concern	Corrective Action

<sup>9</sup> Includes pig launcher/receivers at the Tioga Compressor Station (MP 0.0) and the Norse Transfer Station (MP 20.3). Restoration included backfilling at both locations. Final restoration of the Line Section 25 pig launcher/receiver at the Tioga Compressor Station will be completed in conjunction with the final restoration of the station. The Norse Transfer Station pig launcher/receiver had a security fence installed and gravel spread in conjunction with the restoration of the Norse Transfer Station.

<sup>10</sup> Includes block valves at Valve No. 6.8 at 102<sup>nd</sup> Road (MP 6.9) and Valve No. 13.6 at 81<sup>st</sup> Street (MP 13.6). Restoration included backfilling, a security fence installed, and gravel spread at each location.

**TABLE 1-8  
Uprates to Line Section 25**

<b>Work Completed during Reporting Period:</b>				
<ul style="list-style-type: none"> <li>No work was completed during this reporting period.</li> </ul>				
Activity	Total % Completed This Period	% of Total Job Completed	Comments	
<b>Pipeline <sup>11</sup></b>				
Clearing / Grading		100%		
Stringing		100%		
Bending		100%		
Welding		100%		
Joint Coating		100%		
Ditching		100%		
Lowering		100%		
Backfill		100%		
Cleanup		100%		
Seeding		100%		
Pig Launcher/Receiver <sup>12</sup>		3 of 3	Pig launcher/receivers completed	
Bores <sup>13</sup>		4 of 4	Bores completed	
Hydrostatic Testing		100%		
<b>Work Planned for next Reporting Period and Schedule Changes:</b>				
<ul style="list-style-type: none"> <li>No work is planned for the next reporting period.</li> </ul>				
<b>Problem Areas, Corrective Actions and Effectiveness:</b>				
<ul style="list-style-type: none"> <li>No problem areas were identified during reporting period.</li> </ul>				
<b>Non-Compliance Issues, Corrective Actions and Effectiveness:</b>				
<ul style="list-style-type: none"> <li>No non-compliance issues were identified during reporting period.</li> </ul>				
<b>Non-Compliance Issues from Federal, State or Local Permitting Agencies and Response:</b>				
<ul style="list-style-type: none"> <li>No non-compliance issues were identified during reporting period.</li> </ul> Copies included: Not applicable				
<b>Landowner Issues:</b> None				
Date	Name	Milepost / Alignment Sheet #	Problem/Concern	Corrective Action

<sup>11</sup> Includes replacing the existing 0.1 mile 6-inch-diameter Stoneview-Conoco Lateral with 0.1 mile of 8-inch-diameter natural gas pipeline from the Norse Transfer Station to the existing Line Section 25 and the replacing and rerouting about 0.1 mile of existing 8-inch-diameter pipeline from the 86th Street NW bore to the proposed Norse Transfer Station.

<sup>12</sup> Includes three 8-inch pig launcher/receivers for the existing Line Section 25 with one at the Lignite Receipt Station and two at the new Norse Transfer Station (one northbound and the other southbound). Restoration included backfilling with a security fence installed and gravel spread in conjunction with the restoration at each station.

<sup>13</sup> Includes the replacement of about 0.4 mile of existing pipeline via the guided bore method at four county road crossings and one state highway crossing (92nd Street NW; 93rd Street NW/89th Avenue NW (both crossed by the same bore); 86th Street NW, and Highway 40).

**C. Construction Status – Aboveground Facilities**

<b>TABLE 2-1 Tioga Compressor Station</b>				
<b>Work Completed during Reporting Period:</b>				
<ul style="list-style-type: none"> <li>No work was completed during this reporting period.</li> </ul>				
Activity	Total % Completed This Period	% of Total Job Completed	Comments	
Initial Site Work		100%		
Waste Systems		100%		
Foundations & Concrete		100%		
Installation of Buildings		100%		
Installation of Piping		100%		
Installation of Structural Supports		100%		
Setting of Equipment		100%		
Insulation		100%		
Start-Up & Commissioning - Mechanical		100%		
Start-Up & Commissioning - Electrical		100%		
Cleanup / Restoration		100%		
<b>Work Planned for next Reporting Period and Schedule Changes:</b>				
<ul style="list-style-type: none"> <li>No work is planned for the next reporting period.</li> </ul>				
<b>Problem Areas, Corrective Actions and Effectiveness:</b>				
<ul style="list-style-type: none"> <li>No problem areas were identified during reporting period.</li> </ul>				
<b>Non-Compliance Issues, Corrective Actions and Effectiveness:</b>				
<ul style="list-style-type: none"> <li>No non-compliance issues were identified during reporting period.</li> </ul>				
<b>Non-Compliance Issues from Federal, State or Local Permitting Agencies and Response:</b>				
<ul style="list-style-type: none"> <li>No non-compliance issues were identified during reporting period.</li> </ul>				
Copies included: Not applicable				
<b>Landowner Issues:</b> None				
Date	Name	Milepost / Alignment Sheet #	Problem/Concern	Corrective Action

**TABLE 2-2  
Elkhorn Creek Compressor Station**

**Work Completed during Reporting Period:**

- No work was completed during this reporting period.

Activity	Total % Completed This Period	% of Total Job Completed	Comments
Initial Site Work		100%	
Waste Systems		100%	
Foundations & Concrete		100%	
Installation of Buildings		100%	
Installation of Piping		100%	
Installation of Structural Supports		100%	
Setting of Equipment		100%	
Insulation		100%	
Start-Up & Commissioning - Mechanical		100%	
Start-Up & Commissioning - Electrical		100%	
Cleanup / Restoration		99%	1/

1/ Forty feet of the approach from the county highway will be asphalted in Summer 2022 per the county highway requirements.

**Work Planned for next Reporting Period and Schedule Changes:**

- No work is planned for the next reporting period.

**Problem Areas, Corrective Actions and Effectiveness:**

- No problem areas were identified during reporting period.

**Non-Compliance Issues, Corrective Actions and Effectiveness:**

- No non-compliance issues were identified during reporting period.

**Non-Compliance Issues from Federal, State or Local Permitting Agencies and Response:**

- No non-compliance issues were identified during reporting period.

Copies included: Not applicable

**Landowner Issues:** None

Date	Name	Milepost / Alignment Sheet #	Problem/Concern	Corrective Action



**TABLE 3-1  
Lignite Plant Receipt and Town Border Stations**

<b>Work Completed during Reporting Period:</b>				
<ul style="list-style-type: none"> <li>No work was completed during this reporting period.</li> </ul>				
<b>Activity</b>	<b>Total % Completed This Period</b>	<b>% of Total Job Completed</b>	<b>Comments</b>	
Site Preparation		100%		
Facility Installation		100%	Included meter building, odorization facilities and station piping. 1/	
Cleanup		100%	The fence was installed in February 2022	
1/ No new facilities at the Lignite Town Border station were installed other than a new 2-inch pipe to connect the border station to the new measurement facilities at the receipt station.				
<b>Work Planned for next Reporting Period and Schedule Changes:</b>				
<ul style="list-style-type: none"> <li>No work is planned for the next reporting period.</li> </ul>				
<b>Problem Areas, Corrective Actions and Effectiveness:</b>				
<ul style="list-style-type: none"> <li>No problem areas were identified during reporting period.</li> </ul>				
<b>Non-Compliance Issues, Corrective Actions and Effectiveness:</b>				
<ul style="list-style-type: none"> <li>No non-compliance issues were identified during reporting period.</li> </ul>				
<b>Non-Compliance Issues from Federal, State or Local Permitting Agencies and Response:</b>				
<ul style="list-style-type: none"> <li>No non-compliance issues were identified during reporting period.</li> </ul>				
Copies included: Not applicable				
<b>Landowner Issues:</b> None				
<b>Date</b>	<b>Name</b>	<b>Milepost / Alignment Sheet #</b>	<b>Problem/Concern</b>	<b>Corrective Action</b>

**TABLE 3-2  
Norse Plant Receipt Station**

<b>Work Completed during Reporting Period:</b>				
<ul style="list-style-type: none"> <li>No work was completed during this reporting period.</li> </ul>				
Activity	Total % Completed This Period	% of Total Job Completed	Comments	
Site Preparation		100%		
Facility Installation		100%		
Cleanup		100%		
<b>Work Planned for next Reporting Period and Schedule Changes:</b>				
<ul style="list-style-type: none"> <li>No work is planned for the next reporting period.</li> </ul>				
<b>Problem Areas, Corrective Actions and Effectiveness:</b>				
<ul style="list-style-type: none"> <li>No problem areas were identified during reporting period.</li> </ul>				
<b>Non-Compliance Issues, Corrective Actions and Effectiveness:</b>				
<ul style="list-style-type: none"> <li>No non-compliance issues were identified during reporting period.</li> </ul>				
<b>Non-Compliance Issues from Federal, State or Local Permitting Agencies and Response:</b>				
<ul style="list-style-type: none"> <li>No non-compliance issues were identified during reporting period.</li> </ul> Copies included: Not applicable				
<b>Landowner Issues:</b> None				
Date	Name	Milepost / Alignment Sheet #	Problem/Concern	Corrective Action

**TABLE 3-3  
Norse Transfer Station**

<b>Work Completed during Reporting Period:</b>				
<ul style="list-style-type: none"> <li>No work was completed during this reporting period.</li> </ul>				
Activity	Total % Completed This Period	% of Total Job Completed	Comments	
Site Preparation		100%		
Facility Installation		100%		
Cleanup		100%		
<b>Work Planned for next Reporting Period and Schedule Changes:</b>				
<ul style="list-style-type: none"> <li>No work is planned for the next reporting period.</li> </ul>				
<b>Problem Areas, Corrective Actions and Effectiveness:</b>				
<ul style="list-style-type: none"> <li>No problem areas were identified during reporting period.</li> </ul>				
<b>Non-Compliance Issues, Corrective Actions and Effectiveness:</b>				
<ul style="list-style-type: none"> <li>No non-compliance issues were identified during reporting period.</li> </ul>				
<b>Non-Compliance Issues from Federal, State or Local Permitting Agencies and Response:</b>				
<ul style="list-style-type: none"> <li>No non-compliance issues were identified during reporting period.</li> </ul> Copies included: Not applicable				
<b>Landowner Issues:</b> None				
Date	Name	Milepost / Alignment Sheet #	Problem/Concern	Corrective Action

**TABLE 3-4  
Northern Border Interconnect**

<b>Work Completed during Reporting Period:</b>				
<ul style="list-style-type: none"> <li>No work was completed during this reporting period.</li> </ul>				
Activity	Total % Completed This Period	% of Total Job Completed	Comments	
Site Preparation		100%		
Facility Installation		100%		
Cleanup		99%	1/	
1/ Fifty feet of the approach from the county highway will be asphalted in Summer 2022 per the county highway requirements.				
<b>Work Planned for next Reporting Period and Schedule Changes:</b>				
<ul style="list-style-type: none"> <li>No work is planned for the next reporting period.</li> </ul>				
<b>Problem Areas, Corrective Actions and Effectiveness:</b>				
<ul style="list-style-type: none"> <li>No problem areas were identified during reporting period.</li> </ul>				
<b>Non-Compliance Issues, Corrective Actions and Effectiveness:</b>				
<ul style="list-style-type: none"> <li>No non-compliance issues were identified during reporting period.</li> </ul>				
<b>Non-Compliance Issues from Federal, State or Local Permitting Agencies and Response:</b>				
<ul style="list-style-type: none"> <li>No non-compliance issues were identified during reporting period.</li> </ul> Copies included: Not applicable				
<b>Landowner Issues:</b> None				
Date	Name	Milepost / Alignment Sheet #	Problem/Concern	Corrective Action

**TABLE 3-5  
Robinson Lake Plant Receipt Station**

<b>Work Completed during Reporting Period:</b>				
<ul style="list-style-type: none"> <li>No work occurred during the reporting period.</li> </ul>				
Activity	Total % Completed This Period	% of Total Job Completed	Comments	
Site Preparation		100%		
Facility Installation		100%		
Cleanup		100%		
<b>Work Planned for next Reporting Period and Schedule Changes:</b>				
<ul style="list-style-type: none"> <li>No work is planned for the next reporting period.</li> </ul>				
<b>Problem Areas, Corrective Actions and Effectiveness:</b>				
<ul style="list-style-type: none"> <li>No problem areas were identified during reporting period.</li> </ul>				
<b>Non-Compliance Issues, Corrective Actions and Effectiveness:</b>				
<ul style="list-style-type: none"> <li>No non-compliance issues were identified during reporting period.</li> </ul>				
<b>Non-Compliance Issues from Federal, State or Local Permitting Agencies and Response:</b>				
<ul style="list-style-type: none"> <li>No non-compliance issues were identified during reporting period.</li> </ul> Copies included: Not applicable				
<b>Landowner Issues:</b> None				
Date	Name	Milepost / Alignment Sheet #	Problem/Concern	Corrective Action

**TABLE 3-6  
Springbrook Plant Receipt Station**

Activity	Total % Completed This Period	% of Total Job Completed	Comments	
Site Preparation		0%		
Facility Installation		0%		
Cleanup		0%		
<p><b>Remaining Work:</b></p> <ul style="list-style-type: none"> <li>WBI Energy, in conjunction with the customer at the Springbrook Plant Receipt Station, have elected not to complete the station upgrade at this time. Any work completed at this station in the future will be done under WBI Energy's blanket certificate authority and will be reported in WBI Energy's Annual Report of Activities Under Blanket Certificate. On March 8, 2022, WBI Energy filed a request with the FERC to vacate the portion of WBI Energy's Certificate authorizing the upgrade of the Springbrook Plant Receipt Station. On April 8, 2022, the FERC issued an Order granting WBI Energy's request.</li> </ul>				
<p><b>Problem Areas, Corrective Actions and Effectiveness:</b></p> <ul style="list-style-type: none"> <li>No problem areas were identified during the reporting period.</li> </ul>				
<p><b>Non-Compliance Issues, Corrective Actions and Effectiveness:</b></p> <ul style="list-style-type: none"> <li>No non-compliance issues were identified during reporting period.</li> </ul>				
<p><b>Non-Compliance Issues from Federal, State or Local Permitting Agencies and Response:</b></p> <ul style="list-style-type: none"> <li>No non-compliance issues were identified during reporting period.</li> </ul> <p>Copies included: Not applicable</p>				
<p><b>Landowner Issues:</b> None</p>				
<b>Date</b>	<b>Name</b>	<b>Milepost / Alignment Sheet #</b>	<b>Problem/Concern</b>	<b>Corrective Action</b>



**TABLE 3-7  
Tioga Plant Receipt Station**

<b>Work Completed during Reporting Period</b>				
<ul style="list-style-type: none"> <li>No work occurred during the reporting period.</li> </ul>				
Activity	Total % Completed This Period	% of Total Job Completed	Comments	
Site Preparation		100%		
Facility Installation		100%		
Cleanup		100%		
<b>Work Planned for next Reporting Period and Schedule Changes:</b>				
<ul style="list-style-type: none"> <li>No work is planned for the next reporting period.</li> </ul>				
<b>Problem Areas, Corrective Actions and Effectiveness:</b>				
<ul style="list-style-type: none"> <li>No problem areas were identified during reporting period.</li> </ul>				
<b>Non-Compliance Issues, Corrective Actions and Effectiveness:</b>				
<ul style="list-style-type: none"> <li>No non-compliance issues were identified during reporting period.</li> </ul>				
<b>Non-Compliance Issues from Federal, State or Local Permitting Agencies and Response:</b>				
<ul style="list-style-type: none"> <li>No non-compliance issues were identified during reporting period.</li> </ul> Copies included: Not applicable				
<b>Landowner Issues: None</b>				
Date	Name	Milepost / Alignment Sheet #	Problem/Concern	Corrective Action

**TABLE 4**  
**Changes to Stream Crossings or**  
**Work in Environmental Sensitive Areas**

**Schedule changes to stream crossings.**

- None during reporting period

**Schedule changes for work in other environmentally sensitive areas.**

- None during reporting period

**Waterbodies Crossed**

Approx. Milepost	Feature ID	Waterbody Name	Crossing Method
<b>Tioga to Elkhorn Creek</b>			
0.8	s-wm-ea-001p	Unnamed tributary to Paulson Creek	Open Cut
2.4	s-wm-ea-002	Unnamed tributary to Dry Fork Creek	Open Cut
12.3	s-wm-ee-001	Unnamed tributary to Beaver Creek	Open Cut
18.2	s-wm-eb-002	Beaver Creek	GuidedBore
24.4	s-wm-eb-003p	Lake Sakakawea	HDD
25.7	o-mk-ee-001	NaturalPond	HDD
27.1	s-mk-eb-001	Unnamed tributary to Sand Creek	Open Cut
27.5	s-mk-ea-001	Unnamed tributary to Sand Creek	GuidedBore
29.0	s-mk-wa-001	Unnamed tributary to Tobacco Garden Creek	GuidedBore
30.3	s-mk-eb-002	Tobacco Garden Creek	GuidedBore
36.5	s-mk-ea-003	Tobacco Garden Creek	GuidedBore
39.2	s-mk-ea-002	Unnamed tributary to Tobacco Garden Creek	Open Cut
44.9	DSK_NHD_11	Timber Prong Creek	GuidedBore
44.9	DSK_NHD_5	Timber Prong Creek	GuidedBore
51.5	s-mk-eb-005	Northfork Creek	GuidedBore
52.4	s-lbt-001a	CherryCreek	GuidedBore
58.0	DSK_NHD_2	Unnamed tributary to Sevenmile Creek	Open Cut
<b>Line Section 25 Loop</b>			
13.4	s-bk-eb-001p	White Earth Creek	GuidedBore
<b>Line Section 30 Loop</b>			
7.2	s-wm-ea-002	Unnamed tributary to Dry Fork Creek	Open Cut
8.8	s-wm-ea-001p	Unnamed tributary to Paulson Creek	Open Cut
<b>Tioga Compressor Station</b>			
NA	o-wm-eb-001	Man-made pond	N/A
<b>Yards</b>			
EngetYard	o-mt-ee-001	Man-made pond	N/A

**Wetlands Crossed or Otherwise Affected by Project**

Approx. Milepost	Feature ID	Crossing Method
<b>Tioga to Elkhorn Creek</b>		
0.9	w-wm-ea-008e	Open Cut
12.8	w-wm-ee-001e	Open Cut
16.9	w-wm-eg-001e	Open Cut
18.0	w-wm-eb-008e	Open Cut
28.0	w-mk-ea-001e	Open Cut
29.3	w-mk-eb-002e	Open Cut
38.5	w-mk-ea-003e	Guided Bore
40.0	w-mk-ef-004e	Open Cut
41.5	w-mk-eb-003e	Open Cut
44.9	DSK_NWI_7	Guided Bore

47.0	w-mk-ea-004e	Guided Bore
51.0	w-mk-eb-004e	Open Cut
52.5	w-lbt-003	Open Cut
52.6	w-lbt-001b	Open Cut
52.6	w-lbt-001a	Open Cut
53.7	w-mk-wa-002e	Open Cut
55.0	w-mk-ef-007e	Open Cut
55.0	w-mk-wa-001e	Open Cut
55.7	w-mk-ef-008e	Open Cut
62.4	w-mk-eg-001	Open Cut
<b>Line Section 25 Loop</b>		
0.7	w-wm-eb-002e	Guided Bore
4.7	w-wm-ea-002e	Open Cut
4.8	w-wm-ea-001e	Open Cut
9.8	w-mt-ea-001e	Open Cut
11.0	w-bk-ea-013	Open Cut
11.9	w-bk-ea-005e	Open Cut
11.9	w-bk-ea-006e	Open Cut
13.2	w-bk-ee-002e	Open Cut
13.5	w-bk-eb-001e	Guided Bore
14.8	w-bk-wa-001e	Guided Bore
16.0	w-bk-ea-003e	Open Cut
16.1	w-bk-ea-002e	Open Cut
16.3	w-bk-ea-001e	Guided Bore
<b>Line Section 30 Loop</b>		
0.0	w-wm-ee-002e	Open Cut
0.2	w-wm-ec-004e	Open Cut
0.3	w-wm-ec-005e	Open Cut
0.4	w-wm-ef-002e	Open Cut
5.8	w-wm-ec-003e	Open Cut
8.7	w-wm-ea-008e °	Open Cut
<b>Uprating Existing Line</b>		
N/A	w-bk-ea-010e	GuidedBore
<b>Access Roads</b>		
N/A	w-wm-eb-009e	N/A - Matting
<b>Yards</b>		
N/A	w-wm-ef-004e	N/A - Matting
N/A	w-wm-ef-005e	N/A - Matting